

Switch off & on

Adjust backlighting & contrast

Raymarine®

ST60+ Depth Instrument

Switch off

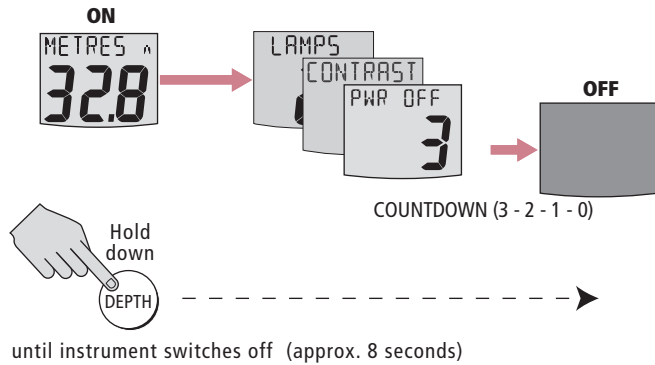

D8331-1

Adjust backlighting

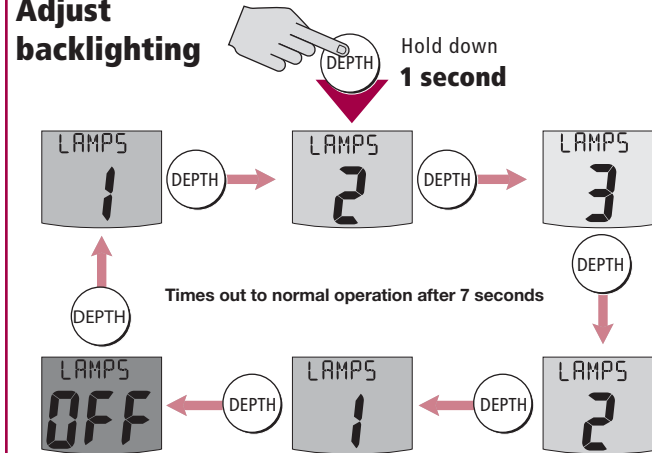

D8332-1

Switch on

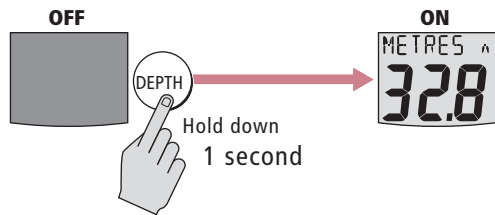

Note:

When power is first applied, the instrument powers up in the ON condition. You do not need to use the **DEPTH** button to switch it on.

D8330-1

Adjust contrast

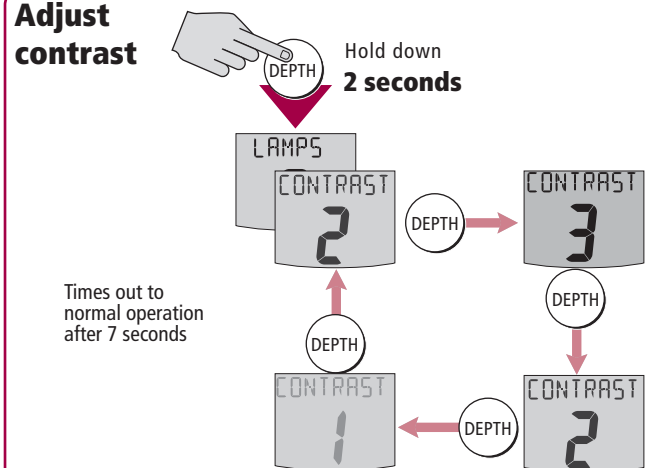

D8333-1



D8334-1

Quick Start Guide

Raymarine®

Raymarine Ltd, Quay Point, Northarbour Road, Portsmouth, Hampshire PO6 3TD, UK +44 (0) 23 9269 3611

Raymarine, Inc, 21 Manchester Street, Merrimack, NH 03054, USA

Toll Free: 800-539-5539

+1 603-881-5200

Document number: 86116-1

Date: December 2005

General operation

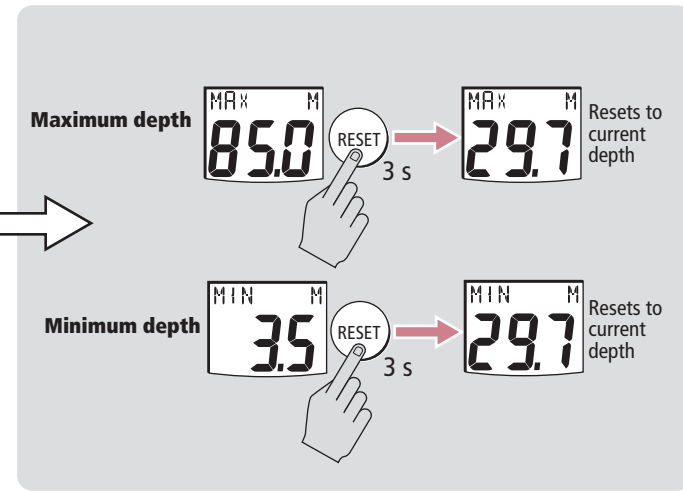
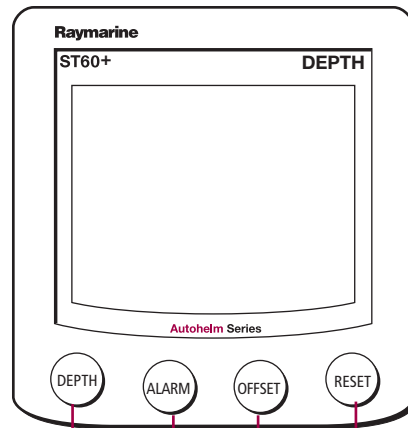
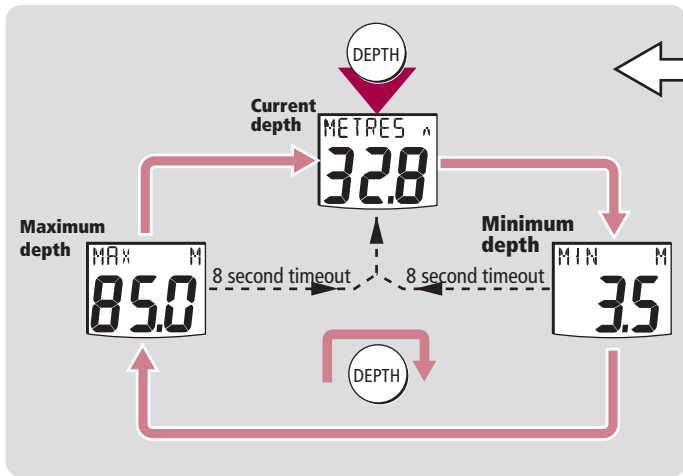

DEPTH
Selects depth information. Also gives access to backlight adjust, contrast adjust and power on/off modes (see overleaf).

RESET
When resettable data are displayed, hold down for 3 seconds to reset the displayed data to the current value.

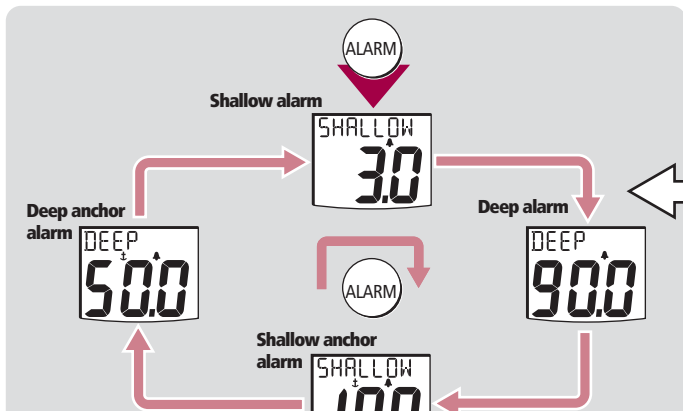

ALARM
Gives access to alarm levels and alarm settings.

OFFSET
Press to see the depth offset.

To adjust an alarm level:

- Select relevant screen then press **OFFSET** + **RESET** to enter adjust mode.
- In adjust mode, use either **OFFSET** or **RESET** to set the alarm level.

To leave adjust mode

Press **OFFSET** + **RESET**

Note:
You can access alarm screens only at master instruments. On repeaters, the **alarm** button has no effect.

WARNING:
If incorrect offset values are applied, this could result in misleading depth information being displayed, with a consequent risk of running aground. Before using your Depth instrument, refer to your ST60+ Depth Instrument Owner's Handbook for information on correctly setting the depth offset.

