

Default Display

Targets:

Landmass

Channel buoy

Surface vessel

Status Bar

Range rings
The number and spacing depend on the current range, or you can turn them off

Ship's Heading Marker (SHM)
You can hide this temporarily

Cursor position, controlled by the trackpad

Ship's position
You can move this off-centre if required

Bearing scale, each tick indicating 10 of azimuth

Cursor position box
Shows the current cursor position as either Range/Bearing or Lat/Long. You can move this box to your preferred position on the screen, or turn it off.

Cursor position box
CURSOR
BRG 045° R
RNG 0.28 nm

Default soft key labels
These can be turned off; press any soft key to re-display them. Different labels are displayed when you press a key.

Context Sensitive Cursor Control

When the cursor is positioned over special features on the display, a text label appears to identify the feature. Depending on the feature, you can then move, re-size or delete it.

Text Label	Feature
BOX	Data box (any type)
CTR	Radar centre
EBL	Electronic Bearing Line
FLT	Floating VRM/EBL
GRD	Guard zone corner or side
MARPA	MARPA Target
MOB	Man Overboard Marker
MRK	Mark
SHM	Ship's Heading Marker
VRM	Variable Range Marker
VRM/EBL	VRM and EBL
WPT	Chart Waypoint
ZMB	Zoom box

Delete (for example, an EBL)

- Cursor over feature, text label appears.
- Press CLEAR to delete.

Move (for example, an EBL)

- Cursor over feature, text label appears.
- Press ENTER to activate move.
- Move using trackpad.
- Press ENTER to confirm.

HDG MODE
NORTH UP COURSE UP HEAD UP TRUE REL
Press the required soft key to change the heading or motion mode, and press ENTER.

TARGETS
INT REJ OFF ON EXPANSION OFF ON WAKES OFF S M L CLEAR WAKES
Press the soft key to toggle INTerference REjection or Target EXPANSION on/off. Press the WAKES soft key until the required option (short, medium or long wakes, or OFF) is highlighted. Press ENTER to accept. Press CLEAR WAKES to clear existing wakes from the display.

SCREEN
CRSR BOX OFF ON RNGE RNGS OFF ON DATABOXES OFF ON WAYPOINT OFF ON
Press the appropriate soft key to toggle on/off Cursor Readout Databox, Range Rings, Data Boxes or Waypoint display, and press ENTER to accept.

MARPA
CANCEL TARGET MARPA BOX OFF ON ACQUIRE TARGET MARPA LIST
Press the appropriate soft key to acquire or cancel selected target. Press the appropriate soft key to view the target data box or database list.

Status Bar

Mode Indicators displayed when function on:

Selected range, in nautical miles	Range rings (displayed if rings are on)	Motion Mode Relative Motion True Motion	Target Vectors True Vector or Relative Vector and vector length	Auto mode Gain, Sea, Tune Wakes	Target Expansion Guard Zone Alarms
3nm	RINGS 1/2	126°T	RM RV3 H-UP	AUTO GST MKS FTC	EX RC IR
Range ring interval Not displayed if range rings are off	Current heading if data available, or Course Over Ground. Displayed in degrees Magnetic or True	Heading mode Normally Head Up (H-UP); Course Up (C-UP) or North Up (N-UP) can be selected if heading data available	FTC (Remote rain)	Interference Rejection	Rain Clutter

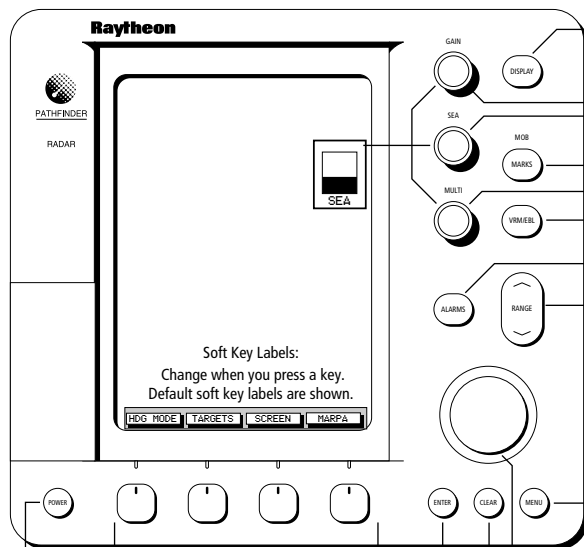

Soft keys
Press to select option, or highlight option or slider. Labels change when you press soft/dedicated key. Elipses (...) after the text indicate that pressing soft key leads to a further display of soft key options.

ENTER
Confirms selection and (if appropriate) clears current soft key labels. It either performs the selected task, accepts changes, or leads to display of more options. When cursor text is displayed, cursor takes control of the object. When arrow-head cursor symbol is displayed, drops the object under cursor control.

CLEAR
Cancels operation in progress and returns to previous display. Deletes an object/function under cursor control.

Trackball
Controls cursor position on screen, the sliders and setup options.

POWER
Press and hold until unit beeps to turn on display. Press to toggle between Standby and Transmit. Press for 3 seconds to turn off display.

GAIN and SEA
Controls for background noise (speckle) and sea clutter.
- Press for soft keys display.
- In MANUAL mode, turn knob to adjust setting.

Press soft key to toggle between Auto/Man. Turn knob to adjust slider, and press **ENTER** to finish.

MULTI
Controls display contrast and brilliance, key lighting, rain clutter around the vessel (RAIN), distant rain clutter (FTC), guard zone alarm sensitivity and tuning the receiver.
- Press to display slider, options and soft keys.
- use trackball to highlight option in list.

Press soft key (if appropriate) to toggle highlighted option between ON/OFF or between AUTO/MAN. Turn knob to adjust slider setting of highlighted option. Press **ENTER** to finish.

ALARMS
Used to control guard zones.
- Press soft key to place guard zone if one not already placed. Adjust size/shape using trackball, press **ENTER** to finish.
- Press to display soft keys if guard zone already placed.

Use soft key to toggle zone ON or OFF. Adjust size/shape using trackball, press **ENTER** to finish.

RANGE
Controls range scale. Range scale and range rings are shown in the Status Bar.
- Press top of key to increase the range scale.
- Press bottom of key to decrease the range scale.
- Press and hold to change the scale faster.

DISPLAY
Controls display mode and windows.
- Press for display mode and soft keys display.
- Press again to toggle through display modes, then **ENTER**.
- Press and hold for 2 seconds for full page radar display.

Press WINDOWS soft key to toggle window on/off, or return to full screen. Zoom: Press ZOOM key to display Zoom Window options. Move Zoom box using trackball, press **ENTER** to finish.

MARKS / MOB
Controls placing marks, and Man Overboard function.
- Press for soft keys display, then press soft key to place mark.
- Press and hold for 2 seconds to activate or cancel MOB.
- Press **ENTER** to finish.

VRM/EBL
Used to measure range and bearing to/between targets.
- Press to place VRM/EBL if one not already placed. Adjust position using trackball, and press **ENTER** to finish.
- Press to display soft keys if VRM/EBL already placed.

Use softkey to toggle VRM/EBL on or off. Press FLOAT to access float options for existing VRM/EBL. Press VRM/EBL DATABOX to toggle data box display off/on.

MENU
Provides access to setup options.
- Press to display soft keys.

Press soft key to display required setup menu, then use trackball to select option and soft key to change setting. Press **ENTER** to close menu, and **CLEAR** to finish.

Quick Reference Card CRT Display Unit Controls: Pathfinder HSB Radar